

REQUEST FOR PROPOSAL
DESIGN AND CONSTRUCTION OF WASH BAY BREAK-OUT 20'
CONTAINER COMPLETE WITH SHOWER AND TOILET FACILITY

Guyana Shore Base Inc. hereby invites interested companies to submit proposals to ***Design and Construction of Wash Bay Break-Out Container Complete with shower and toilet Facility.***

Scope of Work

- Both modules should comprise of a robust steel outer construction.
- ISO type fittings top/bottom or similar for ease of handling by Crane.
- Interior shall be partitioned into two sections separating showering and toilet facilities.
- All electrical components, lights, extractor fans and switches to conform to international safety standards for use in wet room environments.
- All internal plumbing prepared to outlets ready for installation.

Illustrations for Guidance



Figure. 1

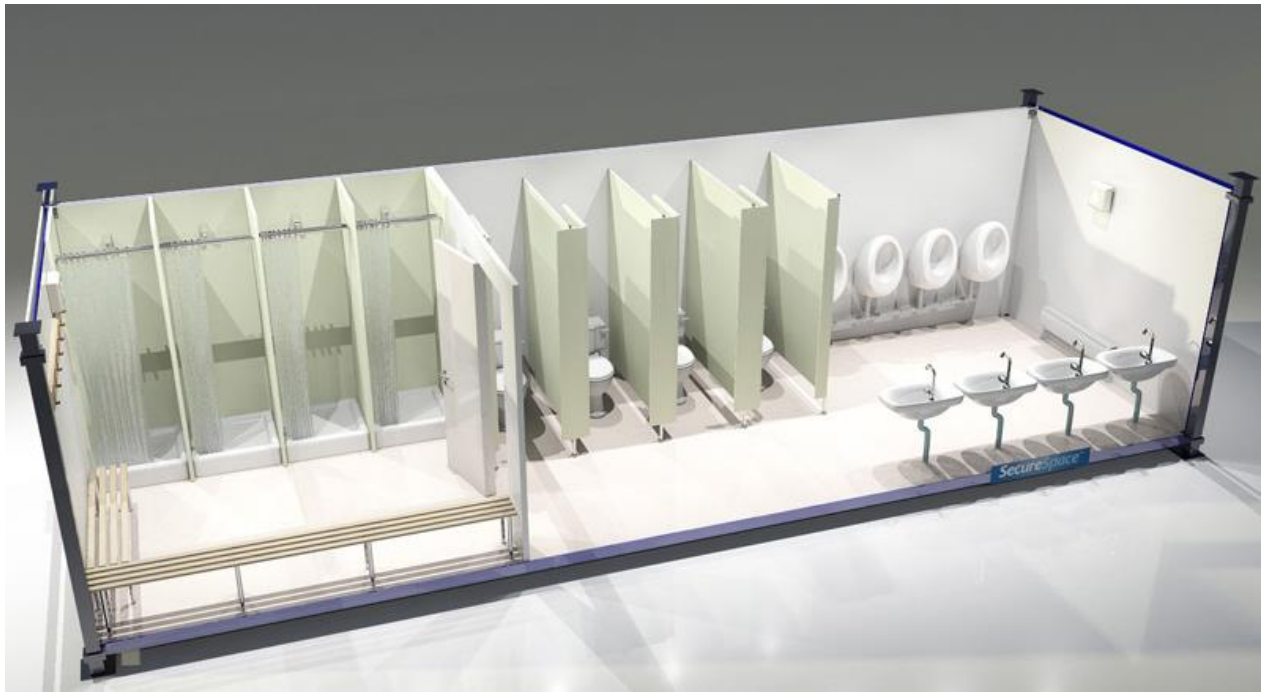

Figure. 2

Annex male shower and toilet facility

Should comprise of the following:

- 3 x Urinals
- 3 x Toilets
- 4 x Sinks
- 5 x Showers /cubicles

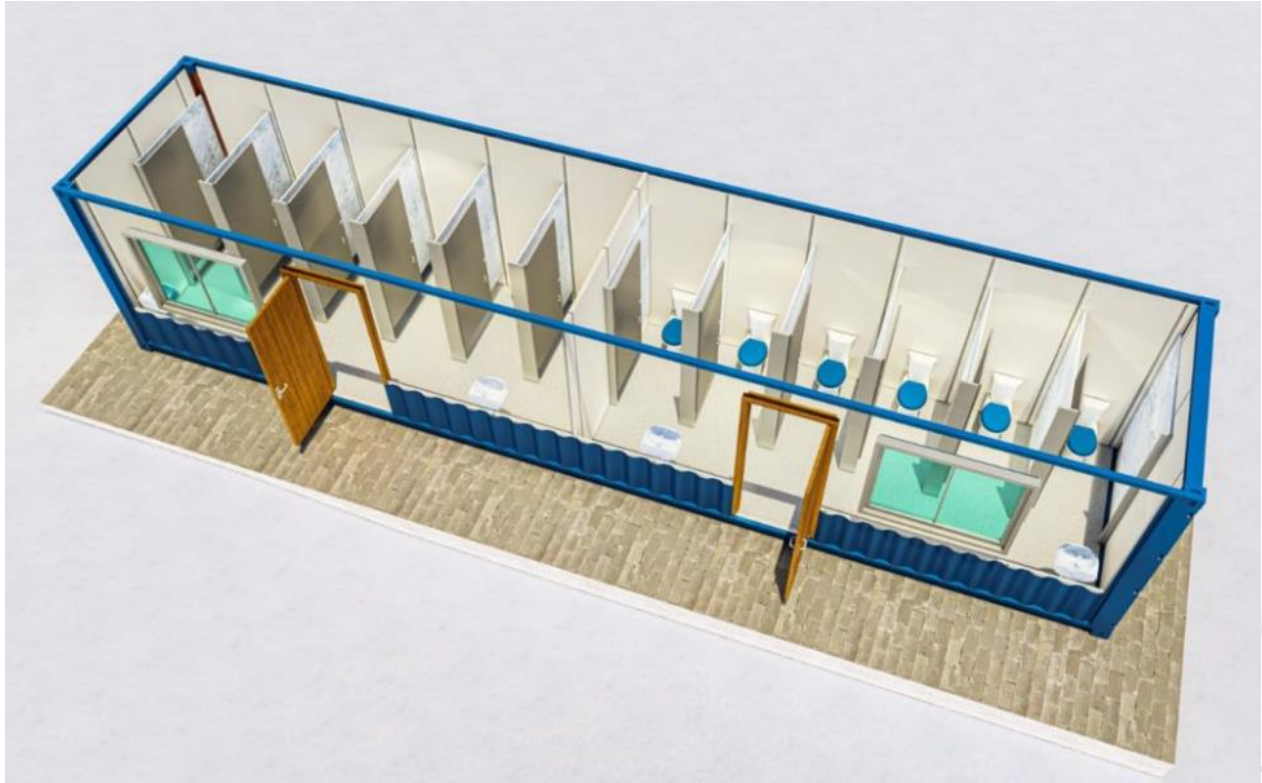

Figure. 3

Annex female shower and toilet facility

Should comprise of the following:

- 4 x Toilets
- 4 x Sinks
- 5 x Showers / cubicles

NB: Preferred suppliers' design may be generic with regards to internal facilities – quantities given are for guidance purposes only.

Instructions to Bidders

1. Proposals are to be submitted along **Valid Business Registration or equivalent, Valid GRA & NIS Compliance, Local Content Certificate.**
2. Proposal and documents must be submitted to the e-mail address below **on or before July 4th, 2023.**

Email: tenders@gysbi.com